

1430 JOH AVENUE

1430 Joh Avenue, Baltimore, MD 21227
Baltimore County



OFFICE/FLEX FOR LEASE

PROPERTY HIGHLIGHTS:

- **Suite K** - 3,000 SF available **NOW**
- 1-story
- Office/flex
- Free and unreserved parking at 3/1,000
- Attractively landscaped
- 24 hour access
- Within 5 minutes of Baltimore's CBD
- Convenient to banks, restaurants & gas stations
- Aggressively priced - \$11.25/SF NNN
- Estimated OpEx - \$4.42/SF

Jim Caronna, SIOR
jcaronna@klnb.com
443-632-2070

100 West Road, Suite 505
Towson, MD 21204
klnb.com

NAIklnb

1430 JOH AVENUE

1430 Joh Avenue, Baltimore, MD 21227
Baltimore County

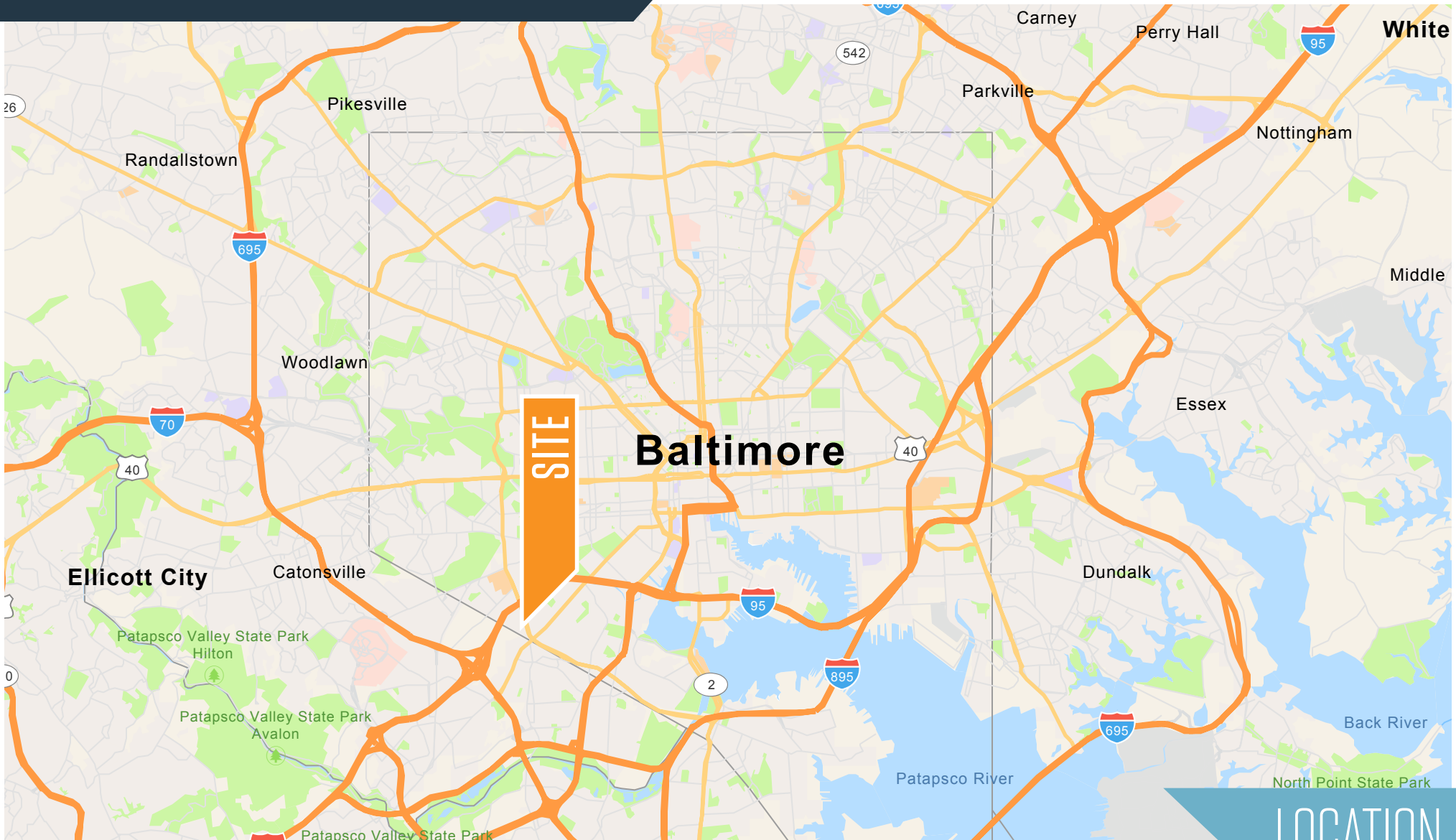

LOCATION

Jim Caronna, SIOR
jcaronna@klnb.com
443-632-2070

100 West Road, Suite 505
Towson, MD 21204
klnb.com



1430 JOH AVENUE

1430 Joh Avenue, Baltimore, MD 21227
Baltimore County

Suite K - 3,000 SF

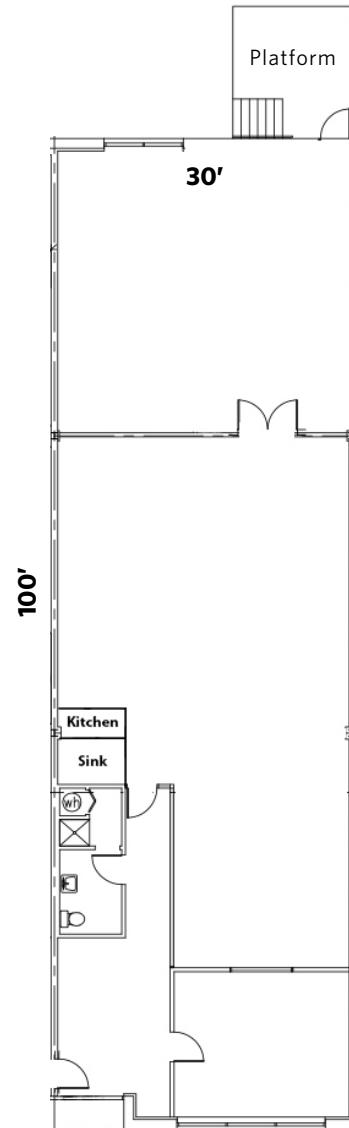

AVAILABILITIES

Jim Caronna, SIOR
jcaronna@klnb.com
443-632-2070

100 West Road, Suite 505
Towson, MD 21204
klnb.com

NAI klnb

1430 JOH AVENUE

1430 Joh Avenue, Baltimore, MD 21227
Baltimore County

CLICK TO VIEW PROPERTY WEBSITE

For More Information, Please Contact:

Jim Caronna, SIOR
jcaronna@klnb.com
443-632-2070

100 West Road, Suite 505
Towson, MD 21204

klnb.com



[instagram.com/klnbcre](https://www.instagram.com/klnbcre)



[linkedin.com/company/klnb](https://www.linkedin.com/company/klnb)



[facebook.com/KLNBCRE](https://www.facebook.com/KLNBCRE)

While we have no reason to doubt the accuracy of any of the information supplied, we cannot, and do not, guarantee its accuracy. All information should be independently verified prior to a purchase or lease of the property. We are not responsible for errors, omissions, misuse, or misinterpretation of information contained herein and make no warranty of any kind, express or implied, with respect to the property or any other matters.

NAI klnb