



2,958 SF ENDCAP AVAILABLE
34 NEW LUXURY CONDOS



2,959 SF ENDCAP

SIGNAGE

SIGNAGE

NEARBY RETAILERS



RETAIL FOR LEASE

- New luxury condo project with 34 condos and 8,789 square feet of prime commercial space
- 2,959 square foot endcap space available
- 26 at grade parking spaces plus 51 garage spaces
- Prime visibility to Maple Ave (29,871 VPD) with multiple full movement access points
- Ideal for bank, credit union, professional services and upscale medical uses

LOCATION

515 MAPLE AVENUE

VIENNA, VA 22180, FAIRFAX COUNTY

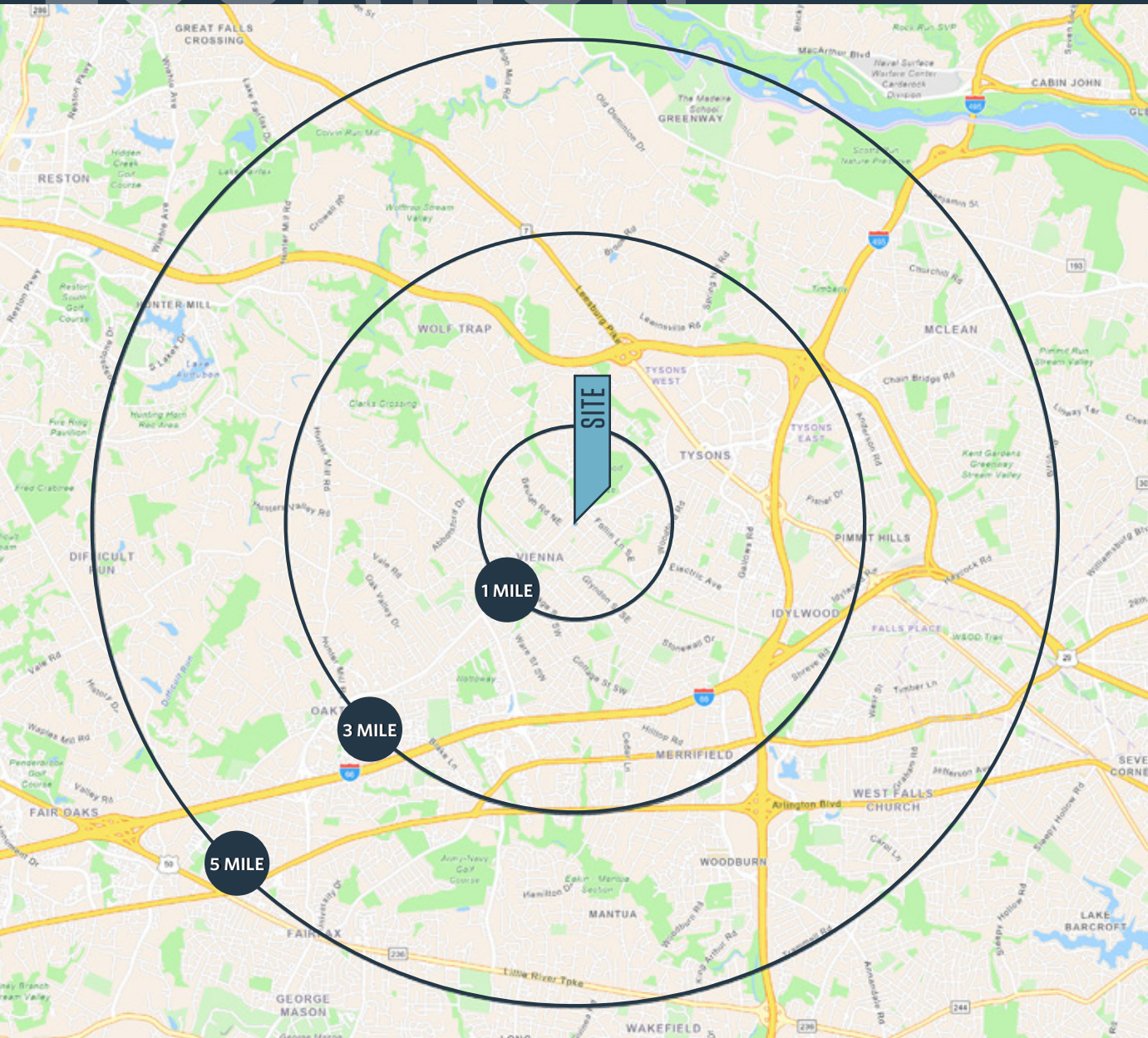

DEMOGRAPHICS | 2025:

1-MILE	3-MILE	5-MILE	10-MIN DRIVE
Population			
10,229	122,801	274,722	88,662
Daytime Population			
13,551	155,694	264,584	166,163
Households			
3,454	48,621	103,258	33,645
Average HH Income			
\$287,327	\$226,263	\$229,248	\$235,859

[CLICK TO DOWNLOAD DEMOGRAPHIC REPORT](#)

TRAFFIC COUNTS | 2024:

Maple Ave 29,871 ADT

MATT SKALET

mkalet@klnb.com | 202-420-7775



MARKET

515 MAPLE AVENUE

VIENNA, VA 22180, FAIRFAX COUNTY

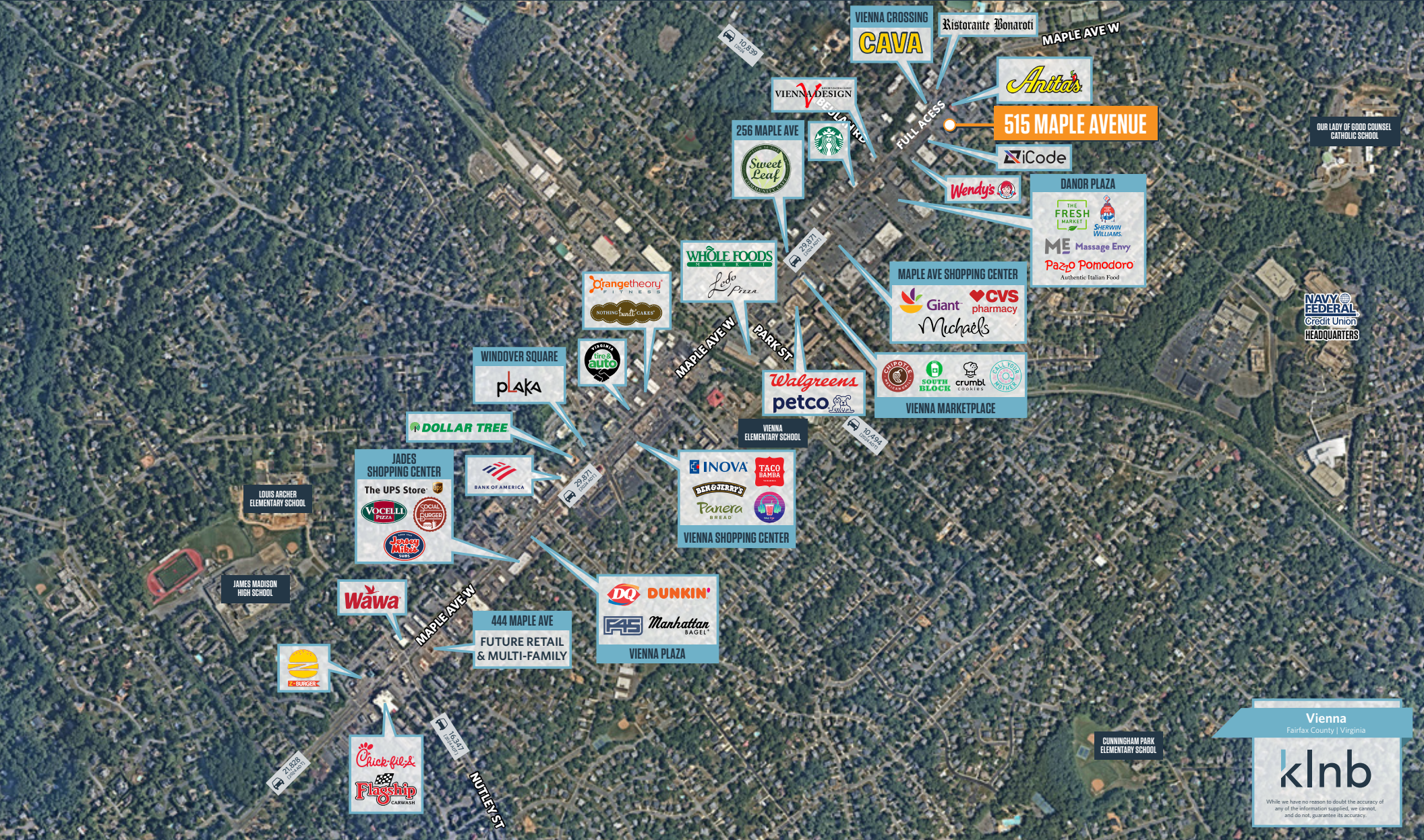

Vienna
Fairfax County | Virginia

klnb

While we have no reason to doubt the accuracy of any of the information supplied, we cannot, and do not, guarantee its accuracy.

MATT SKALET

mkalet@klnb.com | 202-420-7775

klnb

SITE PLAN

515 MAPLE AVENUE

VIENNA, VA 22180, FAIRFAX COUNTY

MAPLE AVE
29,871 (2024 ADT)

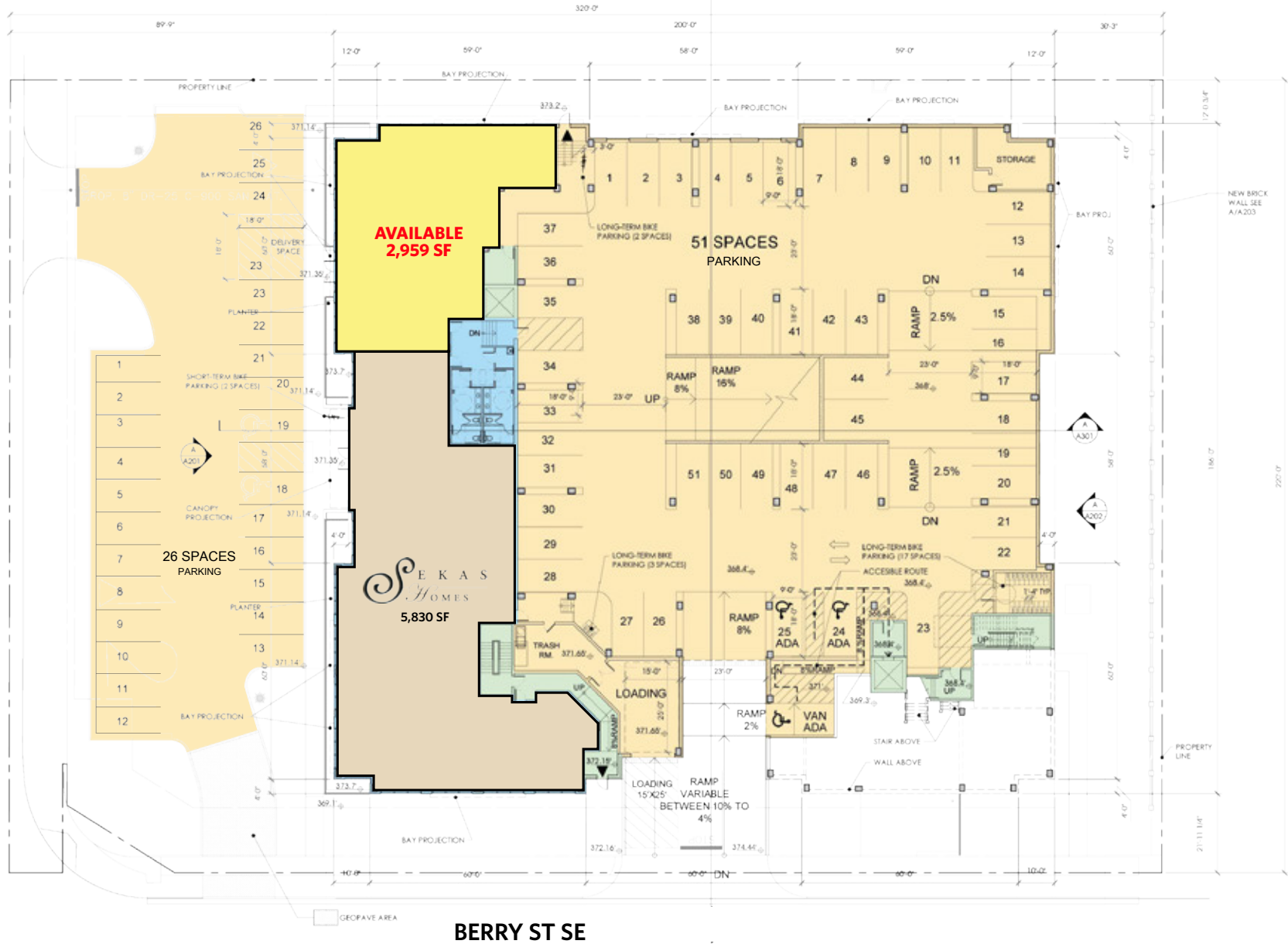

MATT SKALET

mkalet@klnb.com | 202-420-7775





515 MAPLE AVENUE

VIENNA, VA 22180, FAIRFAX COUNTY

FOR MORE INFORMATION, PLEASE CONTACT:

MATT SKALET

mskalet@klnb.com

202-420-7775

1130 Connecticut Ave NW, Suite 600, Washington, DC 20036

.....

klnb.com



[instagram.com/klnbcre](https://www.instagram.com/klnbcre)



[linkedin.com/company/klnb](https://www.linkedin.com/company/klnb)



[facebook.com/KLNBCRE](https://www.facebook.com/KLNBCRE)

[CLICK TO VIEW PROPERTY WEBSITE](#)

While we have no reason to doubt the accuracy of any of the information supplied, we cannot, and do not, guarantee its accuracy. All information should be independently verified prior to a purchase or lease of the property. We are not responsible for errors, omissions, misuse, or misinterpretation of information contained herein and make no warranty of any kind, express or implied, with respect to the property or any other matters.